

The Q-Spa Paris DeLuxe

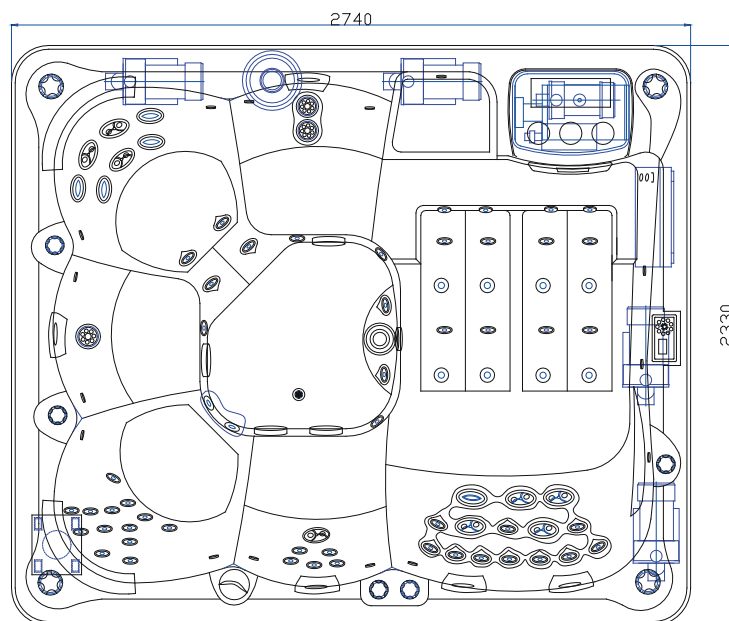

The Q-Spa Paris DeLuxe



Product overview

Among our well-organized range of models you are sure to find the spa bath that matches your lifestyle perfectly. Every Q-spa has been designed to offer optimum enjoyment, each and every day...

Deluxe Version

Dimensions (L x W x H):	274 x 233 x 97,5 cm
Seats:	7
Jets:	76
Pumps:	4 x 3 Hp
24-hour pump:	1 x 0,5 Hp
Heating:	1 x 3 Kw
Airpump:	700w airpump
Voltage/amperage:	3 phase 230V / 24-37A
Airjets:	10
Electrical connection:	3 phase , 3 x C16 + 1x neutral + 1x earth (230~ 240V per phase)
Including:	Fully integrated stereo system; FM/AM radio with MP3 plug-in, four pop up speakers and base speaker. A wooden Spa step (2 steps), to go with the colour of the cabinet.
Extra Deluxe options:	Light therapy with 16 x small LED lights above water, (1 x large LED light underneath the water) & stereo system with MP3 plug-in, pop-up speakers and bass speaker.

